

TECS

Drop off/pick up routes

Private Property

1200 West ST

Thomas Edison
Charter School

Nibley Park Ave.

No parking or drop off/pick up
along Nibley Park Ave.

Loading Zone 1

Loading Zone 2

Loading Zone 3

XXXX
NO car traffic during drop off
and pick up times



per Nibley City, drop-off/pick-up is not
allowed on Nibley Park Ave.

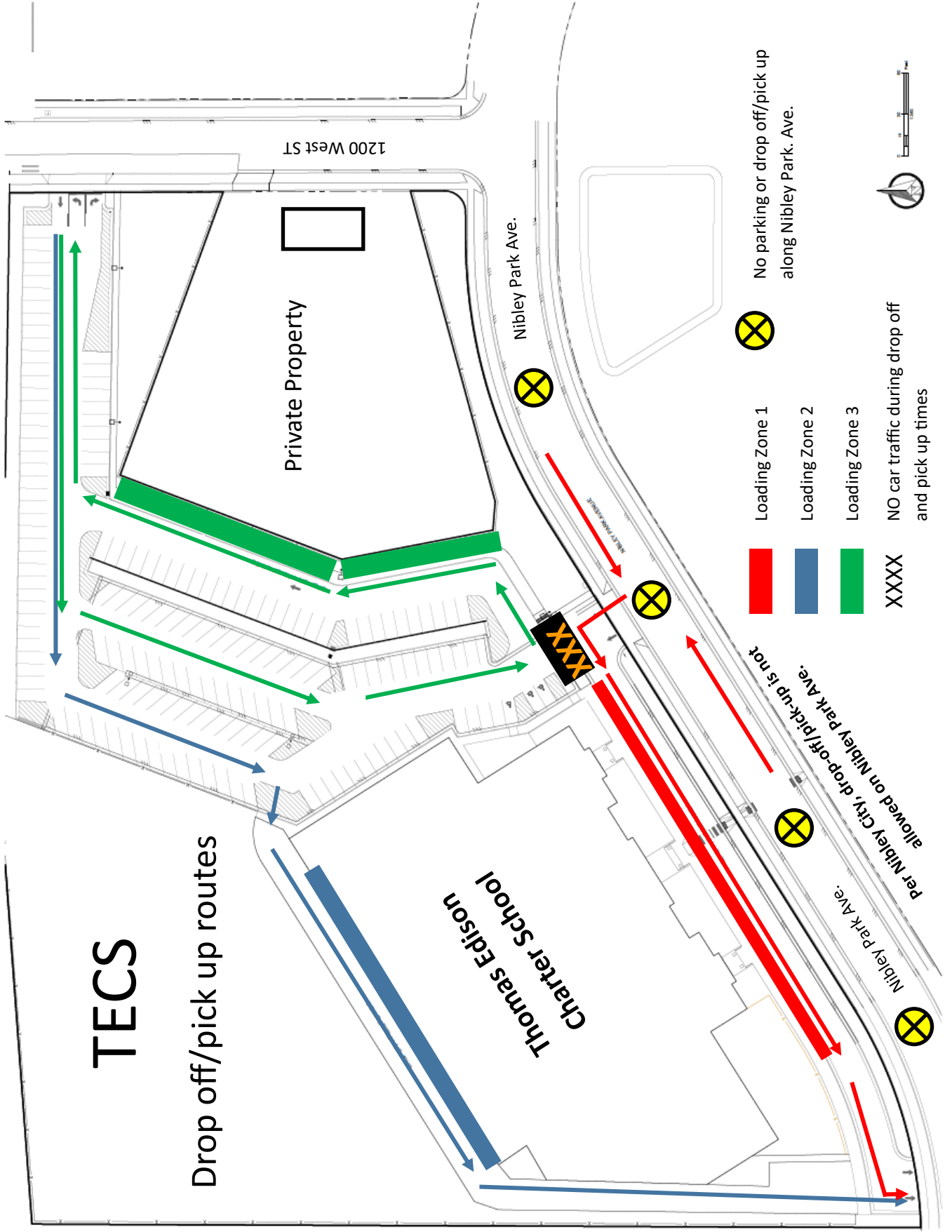



Drop off and Pick up Guidelines

These guidelines are designed to help all traffic move quickly and safely. The safety of each child should always remain everyone's primary concern.

- Please discuss and plan your daily drop-off and pick-up routines in advance.
- Be courteous, patient, cautious and use best judgement.
- Drive slowly, and aware.
- Follow the one-way routes provided. Load and unload at designated areas only. (See adjoining map)
- Loading areas 2 & 3 (blue and green) are accessible from 1200 West during peak times.
- Use the crossing guards and crosswalks.
- The crosswalk east of the school is for **pedestrian traffic only** during peak drop off and pick up times. Vehicles will not be permitted.
- **Drivers should stay with their cars.** If you need to leave your car for ANY reason you **MUST** park in a parking space.
- Escort all students in any driving and parking areas.
- Inform substitute drivers of traffic patterns and student pick-up plan.
- Frequently review guidelines for pick-up and drop off.
- Discuss appropriate behaviors for waiting students (avoid running, throwing objects, and horse play).
- Per Nibley city, student drop off/pick up along Nibley Park Avenue is not allowed.
- *Kindergarten drop-off and pick-up during noon will use the front area.*

NOTE: During the school day, the only entry/exit doors are the front office.

When all of us work together and follow the rules, it provides everyone with a safer, calmer and more predictable atmosphere. Thank you for following the guidelines and teaching those in your carpool!