



WELCOME



START YOUR ENGINES...

WE ARE GOING TO HAVE AN AWESOME YEAR!



Dear TECS families,

Welcome back to another exciting school year! On behalf of the Parent Organization, we extend a warm welcome to all new and returning families.

The Parent Organization's main goal is to support the school community and enhance the educational experience for our children. We work closely with the school administration, teachers, and staff to organize various events, fundraisers, and activities throughout the year.

In preparation for the new school year, we have put together this back-to-school packet for each family. The packet contains important information regarding school policies, upcoming events, volunteer opportunities, and ways to stay engaged in your child's education. Please carefully review the contents and keep them handy for future reference.

We strongly encourage you to get involved in the parent organization and play an active role in your child's education. We meet on the second Thursday of every month at the school. On 'EVEN' months of the year, our meetings are held at **6:30 PM** and on 'ODD' months of the year we meet at **2:00 PM**. These times are rotated to allow for more participation and for all parents to feel included.

Throughout the year, we will keep you informed about our upcoming meetings and volunteer opportunities. We believe that by working together, we can create a fulfilling and enriching educational journey for our children. If you need to reach us please email us at tecspo@edisoncs.org.

We look forward to meeting all of you at Back-to-School night.

Warm regards,

The 2024/2025 Parent Organization Presidency

Nichole Knudson, Jessica Hyer, Tami Kelsey, Michelle Lindsley



Edison South 2024-2025

46	Music	Mckay
----	-------	-------

Restroom	44	43	41	40	36	34
	Art	LA Holm	LA	History	History	Science
	Kropp	Holm	Cureton	Merchant	Catano	Williams

33	LA	Olsen
----	----	-------

32	LA	Fairbanks
----	----	-----------

31	Math	Worley
----	------	--------

30	Math	Hales
----	------	-------

47	Science	Miller
----	---------	--------

45	Lab B	C. Merchant
----	-------	-------------

42	Orchestra	Dunn
39	Band	Wendel

38	37	35
		CTE/Lab
		Dodge

Bingham	Mullen
Reception	SE Conf.
26	27
FRR	SE office

48	K
----	---

49	West	Workroom
----	------	----------

25	5	Madsen
Restroom		

24	5	Walsh
23	5	Knight

22	4	Buchanan
21	4	Gunnell

B	C
A	D
H	E
G	F

50	Lab A	C. Merchant
8	9	
MTSS	Speech	

Restroom	10	12
	2	

14	Library	Jenkins/Wade
16	South	Workroom
18	3	Smith

17	3	Starks
19	3	Killpack

20	4	Jordan
----	---	--------

29 A-H	Jodi Johnson
--------	--------------

2	K	J. Johnson
1	K	S. Hadsell

11	2	Stott
13	2	McGinnis

15	Conf Room	Offices
----	-----------	---------

17	3	Starks
----	---	--------

19	3	Killpack
----	---	----------

20	4	Jordan
----	---	--------

30	Math	Hales
----	------	-------

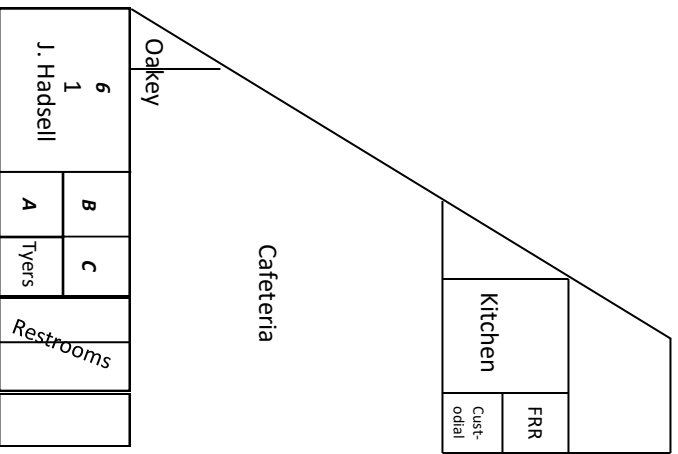

6	1	J. Hadsell
5	1	Bailey
4	1	Kimber
3	K	Larsen
2	K	J. Johnson
1	K	S. Hadsell

8	9
MTSS	Speech

11	2	Stott
13	2	McGinnis

15	Conf Room	Offices
----	-----------	---------

17	3	Starks
----	---	--------

19	3	Killpack
----	---	----------

20	4	Jordan
----	---	--------

30	Math	Hales
----	------	-------



HOW YOUR \$25 DONATION HELPS PAVE A YEAR OF SUCCESS!

CLASS PARTIES

Each elementary class and the middle school has a party 4 times a year. Donations help fund the parties!



SCHOOL ASSEMBLIES AND FAMILY ACTIVITIES

We enjoy organizing the perfect assemblies and activities for our TECS families!

THOMAS EDISON'S BIRTHDAY

In February we celebrate Thomas Edison's birthday by purchasing cupcakes for every student in the school.



FAIRS, SPELLING BEE, FIELD DAY, FUN RUN

From art, science, and history fairs, to Spelling Bee awards, Fun Run medals, and Field Day activities!

TEACHER APPRECIATION

We love to treat our teachers and staff during Teacher Appreciation Week in May! In addition, each year we help with a school improvement project!



THANK YOU FOR YOUR DONATION!

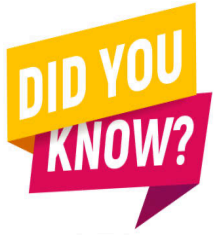

The Parent Organization is entirely run on donations

Please make a family donation of \$25 at the donation table, or via VENMO (@ThomasEdison-South). We appreciate your generosity in helping to provide fun for all the children in our school.

- Spirit Shirt purchasing
- Family Movie Night Concessions
- TECS yearly Fundraiser
- Citrus Fundraiser
- Embroidered school uniform shirts and sweatshirts
- Cache Valley Direct Books
- Swig Fundraiser

In addition to the yearly donation, here are other ways you can help:

- **Smith's rewards**- Link your Smith's Rewards Card to our school -- www.smithsfoodanddrug.com our school code is #80010
- **Box tops**- download the app, create an account, upload your digital receipts within 14 days of purchase.



Please fill out the Google form to hear about volunteer opportunities and PO meetings: <https://forms.gle/fSrxPFuaoAMvZPBE9>



@ThomasEdison-South



venmo

PLEASE DO NOT TURN ON PURCHASE PROTECTION

The school will not receive the full donation, because Venmo takes 1.9% + 10¢ of your payment. If you choose to use purchase protection please include an additional 2% in your payment.

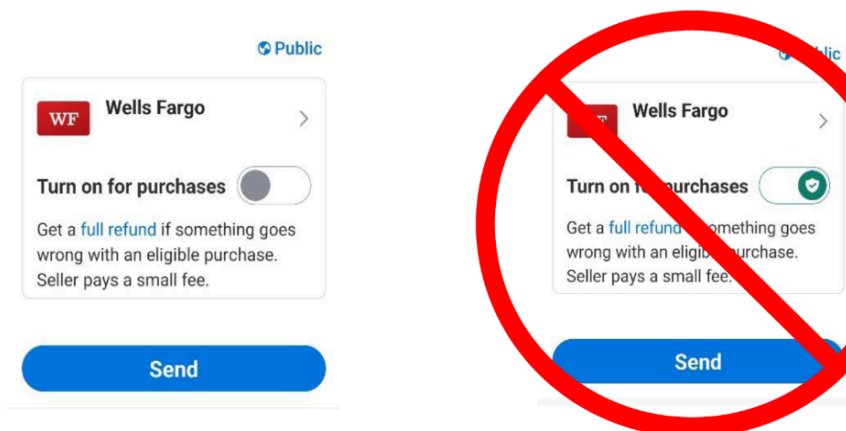

Thank you for your donation!

RACE ON OVER TO THESE UPCOMING PO EVENTS

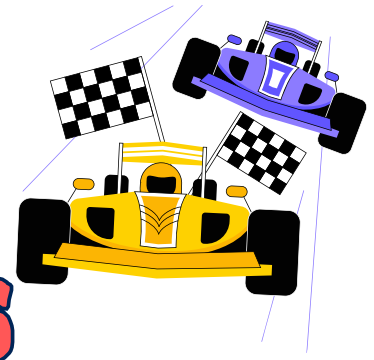

AUG

SWIG DAY FUNDRAISER

SEP

MOVIE NIGHT

OCT

TRICK OR TREAT

NOV

CITRUS FUNDRAISER

DEC

GIVING TREE

JAN

FAMILY BINGO NIGHT

FEB

THOMAS EDISON BIRTHDAY CUPCAKES

MAR

PO ANNUAL FUNDRAISER

APR

VOLUNTEER APPRECIATION

MAY

TEACHER APPRECIATION/FIELD DAY/FUN RUN

2024-2025 PO BOARD CALENDAR

Updated: 6/21/24

Family Bingo Night

August:

- 8 **PO Meeting (6:30 PM) Conference Room**
- 19 Back to School Night 4:30-7:30pm
- 20 Staff Pictures 12-2pm
- 21 First Day of School (K-8)
- 22 Swig Day!

September:

- 2 Labor Day No School
- 5 Student Picture Day
- 9-13 Spirit Week
- 13 Spirit Shirt Day
- 12 **PO Meeting (2:00 PM) Conference Room**
Room Parent Meeting
(12:15 PM & 6 PM Conference Room)
- 16 Constitution Assembly
- 27 Family Movie Night

October:

- 10 **PO Meeting (6:30 PM) Conference Room**
- 10 Student Picture Retake Day
- 15 Dismiss at 1:25 pm - Parent Teacher Conference
- 16 Parent Teacher Conference (No School)
- 17-18 Fall Break (No School)
- 25 Spirit Shirt Day
- 25 Haunted Hallways/Trick or Treat Activity

November:

- 1 Elem. Class Parties/MS Dance
Setup for Giving Tree
- 4 Giving Tree Begins
- 12 Veteran's Day Assembly (*tentatively set*)
- 14 **PO Meeting (2:00 PM) Conference Room**
- 22 School Spelling Bee
- 26 Spirit Shirt Day - Dismiss at 1:25
- 27-29 Thanksgiving Break (No School)

December:

- NO PO Meeting**
- 6 Giving Tree Ends (Items Due Today)
- 20 Elem. Class Parties/MS Party/Spirit Shirt Day
- 23-31 Christmas Break - No School

January:

- 1-3 Christmas Break- No School
- 6 School Resumes
- 9 **PO Meeting (2:00 PM) Conference Room**
- 17-20 Civil Rights Weekend - No School
- 24 Spirit Shirt Day
- 31 Science Fair K-5

February:

- 7 Elem. Class Parties/MS Etiquette Dance
- 11 Thomas Edison's Birthday (cupcakes @ lunch)
- 13 **PO Meeting (6:30 PM) Conference Room**
- 14-17 President's Day Weekend- No School
- 18 President's Day Assembly
- 21 Spirit Shirt Day

March:

- 5 Parent Teacher Conference (Dismiss at 1:25)
- 6 No School - Parent Teacher Conferences
- 7 No School
- 13 **PO Meeting (2:00 PM) Conference Room**
(Chairs Returning next year?/ Run for Officers)
- 21 District Geography Bowl @ North campus
- 22 PO Fundraiser Event
- 28 Spirit Shirt Day
- 31 Spring Break Begins

April:

- 1-5 Spring Break - No School
- 7 School Resumes
- 7-11 Volunteer Appreciation Week
- 11 Spirit Shirt Day
- 10 **PO Ice Cream Social (6:00 PM) Conference Room**
PO Meeting (6:30 PM) Conference Room
(Vote on Officers)
- 23 Administrative Professional Day
- 25 Student Talent Fair/Art Show

May:

- 2 Fun Run
Spirit Shirt Day
Decorate Teacher doors
- 5-9 Teacher Appreciation Week
- 8 **PO Meeting (2:00 PM) in Conference Room**
- 22 Field Day Set-up
- 23 1st--5th Grade Field Day - Dismiss at 12:15
NO LUNCH
- 27-29 Spirit Days
- 27 Teacher "Snack-In" 2:00 pm
- 28 Kindergarten Field Day
- 29 Crazy Hair Day
Kindergarten Graduation
Elem Class Parties
MS Screenplays/Field Day
Last Day of School school ends at 12:15PM

June:

- 12 PO Meeting



- First Day of School is August 21st. All Students should arrive at school by **8:00 AM**. Morning greeting starts at **8:09 AM**.
- School dismisses at **2:55 PM M-TH** and at **1:25 PM every Friday**.
- AM Kindergarten **8:09 - 12:00 AM M-TH** and **8:09-11:00 AM F**
ALL-day Kindergarten **8:09-2:55 PM M-TH** and **8:09 AM -1:25 PM F**
- Be sure to look over the map in this packet that shows the pick up and drop off lanes and discuss where you will plan to meet your child(ren) after school releases.
- Front Desk Office Hours are from **8:00AM-4:30PM M-TH & Friday 8:00 AM-3:30 PM**
- TECS South Campus Telephone Number: **(435) 752-0123**



DRESS CODE

Students are expected to dress and groom themselves in a neat, modest, and attractive fashion reflecting pride in themselves and in their school. The dress code is established to help ensure an atmosphere conducive to study and prevent drawing attention to self. Pride in student dress and grooming is an observable difference at Thomas Edison Charter School. It is the responsibility of parents and children to ensure compliance with the dress code. If there are any questions, keep it simple and err on the conservative side.

All clothing should fit properly and be in good repair. All students must wear closed toe shoes. Neither denim/jeans nor athletic wear (sweats or athletic shorts) are allowed. No logos, designs, lettering, etc. of any kind are allowed, except approved Thomas Edison Charter School logos.

- The official school shirt has a collar, short or long sleeves, and is long enough to remain tucked in. Shirts will be any solid color. Shirts will be one of three styles: polo, oxford, or turtleneck.
- Pants, capris, or knee length shorts will be a solid color in khaki, navy or black. Skirts, skorts, or jumpers may also be approved school plaid. Khaki is defined as the appropriate shade of brown, tan, or green. Examples of approved school plaid are Green Plaid from French Toast Clothing Company or Hunter Classic Navy Plaid from Land's End Clothing Company. Leggings, tights, and "knee high" socks worn with skirts, jumpers, or shorts must be solid color. Pants and shorts will be one of three styles: slacks, cargo, or Docker (the style, not brand).
- Outerwear worn in the building over a dress code shirt for warmth, such as a sweater, cardigan, or vest, must fit all dress code standards except a collar. Appropriate non-dress code outerwear may be worn outside the building.

Occasional exceptions, consistent with the intent of the dress code for special events (such as Boy or Girl Scout uniforms), may be approved by the principal. The principal will interpret and resolve all issues regarding the dress code.

Examples of Appropriate Dress Code Clothing



Peter Pan Collared Shirt



Polo Shirt



Oxford Button Down
Shirt



Turtleneck



Knee Length Skirt



Jumper Dress in
Approved Plaid



Girl's Pants



Dockers

Administrative Interpretations

- ❖ No additional décor on the clothing, such as beads and sequins, even if the same color as the solid color clothing.
- ❖ No excessive and/or non-essential accessories (facial piercings, tattoos or temporary tattoos, multiple earrings, scarves, etc.).
- ❖ Knee length, solid color polo dresses are permitted.
- ❖ Skirts and shorts are to be at least knee length. Leggings may not be used as a substitute for proper length.
- ❖ Clothing must not be form fitting.
- ❖ No jeggings or skinny pants.
- ❖ No hair styles or modified colors that draw attention to self (mohawks, shaved designs, etc.).
- ❖ One solid color layer underneath a dress code shirt for modesty or warmth is acceptable.
- ❖ Optional dress up days for special circumstances may be approved in advance. For such occasions, the standard will always be higher with the traditional dress code modesty standards continuing to apply.
- ❖ Check with the principal ahead of time if there are any questions.



Cargo Shorts/Pants



Drop-off and Pick-up Guidelines

These guidelines are designed to help all traffic move quickly and safely. The safety of each child should always remain everyone's primary concern.

- Please discuss and plan your daily drop-off and pick-up routines in advance.
- Be courteous, patient, cautious and use best judgement.
- Drive slowly, and aware.
- Follow the one-way routes provided. Load and unload at designated areas only. (See adjoining map)
- Loading areas 2 & 3 (blue and green) are accessible from 1200 West during peak times.
- Use the crossing guards and crosswalks.
- The crosswalk east of the school is for **pedestrian traffic only** during peak drop off and pick up times. Vehicles will not be permitted.
- **Drivers should stay with their cars.** If you need to leave your car for ANY reason you MUST park in a parking space.
- Escort all students in any driving and parking areas.
- Inform substitute drivers of traffic patterns and student pick-up plan.
- Frequently review guidelines for pick-up and drop off.
- Discuss appropriate behaviors for waiting students (avoid running, throwing objects, and general horse play).
- All students should be picked up within 15 minutes after school is out unless prearranged between teacher and parent.
- Please help us be good neighbors. Refrain from picking up students in condo area across the street or on private property.
- Nibley City Ordinance states it is illegal and dangerous for our students to be picked up or dropped off along Nibley Park Ave.
- *Kindergarten drop-off and pick-up during noon will use the front area.*

NOTE: During the school day, the only entry/exit doors are the front office.

When all of us work together and follow the rules, it provides everyone with a safer, calmer and more predictable atmosphere. Thank you for following the guidelines and teaching those in your carpool!

TECS

Drop off / pick up routes

Thomas Edison
Charter School

Private Property



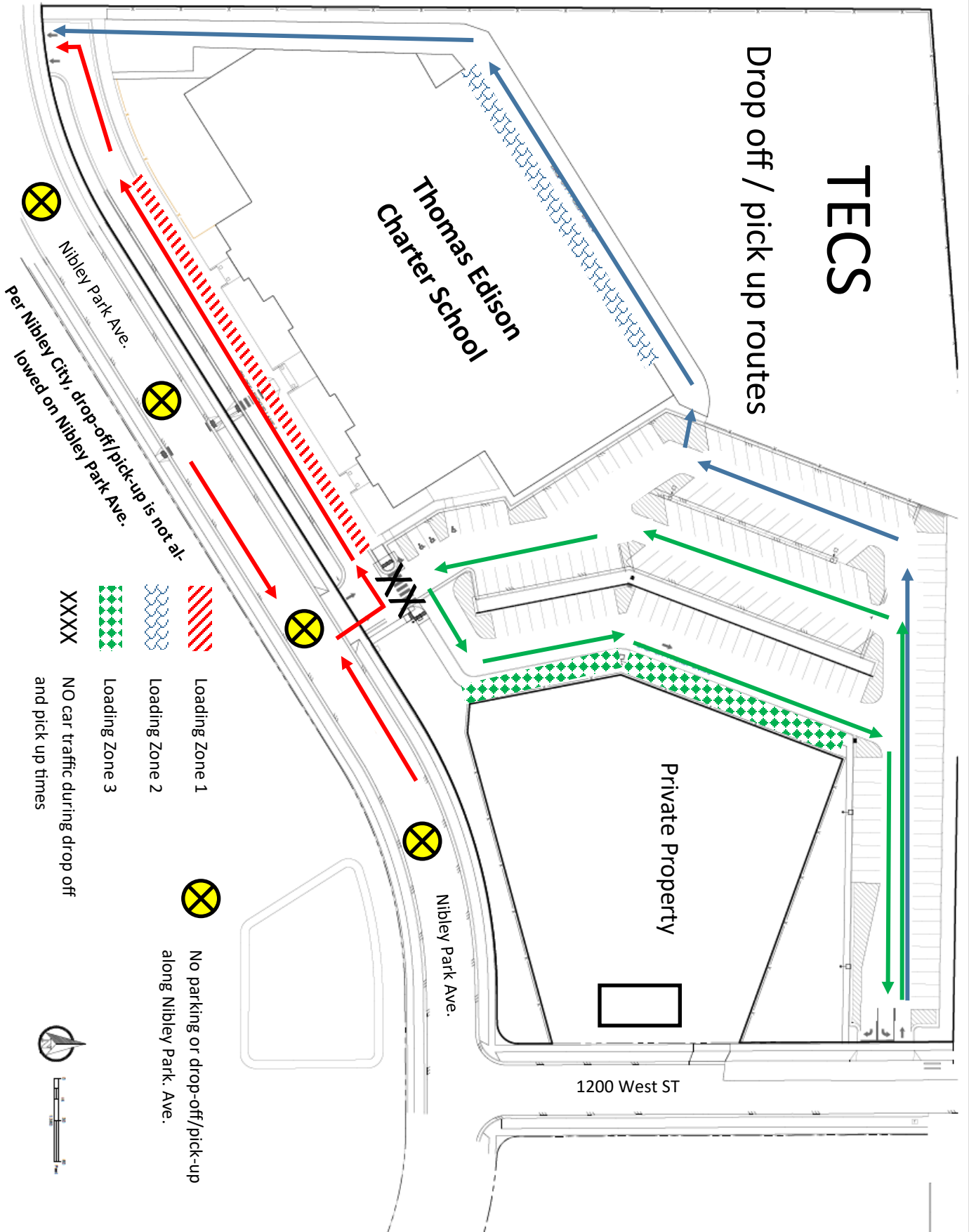

1200 West ST



Nibley Park Ave.

Nibley Park Ave.

Per Nibley City, drop-off/pick-up is not allowed on Nibley Park Ave.

-  Loading Zone 1
-  Loading Zone 2
-  Loading Zone 3
-  No parking or drop-off/pick-up along Nibley Park Ave.
-  NO car traffic during drop off and pick up times



Create your own account to see your child's grades

Go to: <https://thomasedno.usoe-dcs.org/Login.aspx>

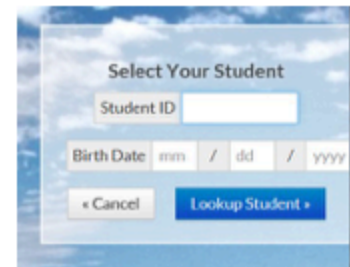
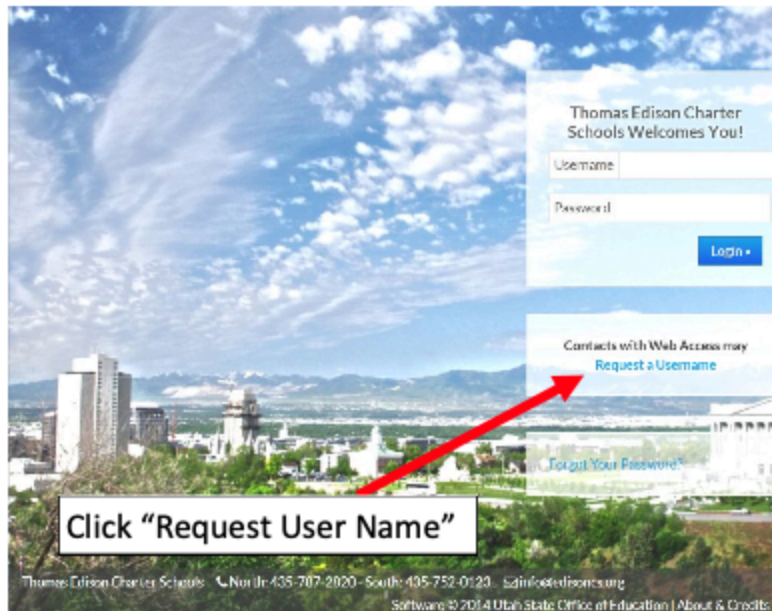

Fill in the student ID and birth date of one of your children. You will be able to access all of your children's information with one account.

Student ID is on your child's schedule or you may contact the office for the information.

Accessing grades from your mobile device

Once you create an account you will be able to access your account from your smart phone.

Open <https://thomasedno.usoe-dcs.org/Login.aspx> on your browser. You can access the full website.

You can also choose the mobile site by clicking on "Visit Our Mobile Website".

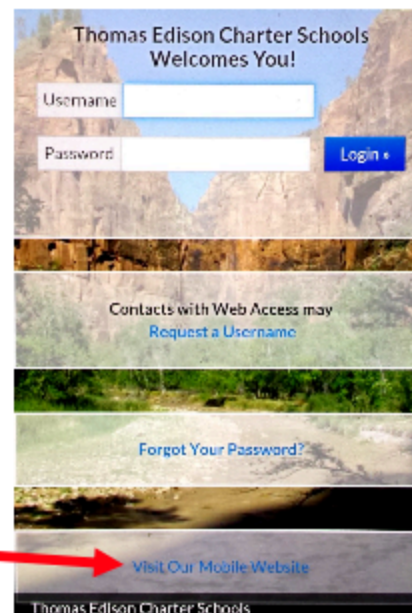

KEEPING UP WITH YOUR STUDENTS GRADES



Automatic Emails Sent to You!

THOMASED.ORG

- **GRADEBOOK**
 - **LOG IN**
 - **SELECT STUDENT ACCOUNT**



**LOOK TO THE UPPER RIGHT HAND
CORNER "SUBSCRIPTIONS"**

- **CLICK INTO MANAGE
SUBSCRIPTIONS**
 - **SELECT "RECEIVE THIS
STUDENTS SUMMARY VIA
EMAIL"**
 - **CHOOSE TIMEFRAME (WEEKLY
OR DAILY)**

RECOMMENDED WEEKLY AS TEACHERS ARE EXPECTED TO UPDATE GRADES ON A WEEKLY BASIS

**ADD AN EMAIL THAT YOU
CHECK REGULARLY**

**REPEAT FOR EACH STUDENT
ACCOUNT**



SCHOOL LUNCH



Lunch Ordering Website: <https://mymealorder.com>.

(Link and instructions can also be found on our website under “Quick Links”.)

1. Create a free account
2. Click on my account
3. Input account settings
4. On the right add your students & payment options
5. Select week view or month view
6. Click on green bar to save your settings

To order:

1. Click on tab on top of screen that says meals.
2. Click the arrow tab to the week you are ordering for
3. Select meals for the week
4. Make sure to select add to cart for each meal
5. To purchase select the green view cart tab on left of screen
6. To finalize order, click the green check out button
7. To cancel order, click empty cart

****Lunch must be ordered 8 days in advance to receive lunch.****

Note: there are no hot lunch options on Thursdays OR Fridays!

Please bring lunch from home.